

| Track | Flux | CCT | Optic | A (mm) |
|---------|------|-------|------------------------------|--------|
| PSU | 205 | 840 | HNB/HMB/HVBR/HVVR/HOVL/HHOVL | 158 |
| | 495 | PW930 | NB/MB/WB/VVBR/OVLV | 162 |
| DIA | | | | 253 |
| DIA-VLC | | | All | 253 |
| WA | | | | 224 |

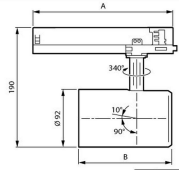

| Flux | CCT | B (mm) |
|------|------------|--------|
| 275 | FMT/Rose/R | 130 |
| 395 | FR/p930 | 149 |
| 495 | | |



Specifications Philips LED Tracklight GreenSpace Evo Projector White 30W 4000lm 41x80D - 830 Warm White | Dali Dimmable

[View Product](#)

General Information

| | |
|--------------------------|---------------------------------|
| SKU | 251907 |
| EAN | 8720169590977 |
| Brand | Philips |
| Manufacturer Name | ST333T 39S/830 DIA-VLC WB WH481 |
| Any Lamp all-in warranty | 5 Years |
| Average Lifetime (h) | 50000 |

Technical Information

| | |
|-----------------------------|--------------------|
| Technology | LED Integrated |
| Wattage | 30 |
| Replaces (Watt) | 50 |
| Voltage (V) | 220-240 |
| Dimmable | Dimmable with Dali |
| Colour Code | 830 Warm White |
| Colour temperature (Kelvin) | 3000 Warm White |
| Colour Rendering (Ra) | 80-89 |
| Colour of Light | White |
| Light colour options | Single Color |
| Luminous Flux (Lumen) | 4000 |
| Luminous Efficacy (lm/W) | 138 |

Emergency Lighting No Emergency Unit

Beam Angle (degree) 41x80

Power factor >0.90

Product Type Category LED Trackspot

Fixture Information

Mounting Method Rail

Operating Temperature 0 to +25

IP-rating IP20

Impact Protection (IK) IK02 - 0.20 joule

Housing Plastic

Colour of the Fixture White

Colour of material White

Dimensions

Length (mm) 253

Width (mm) 92

Height (mm) 190

Sensor Information

Type of sensor No Sensor

Why Any-lamp?

 Order from the **largest lighting specialist** in Europe  **Customised** quotation

 Up to **7 years warranty**  **Easy** return process